

结构特点 Design features

- 内装、单端面、金属波纹管、平衡型、旋转式密封；
- 紧定螺钉传动结构，任意旋向，压力均匀，结构简单、紧凑，安装方便，泄漏点少，密封性能可靠；
- Internally mounted, single face, metal bellows, balanced, rotary type seal.
- Driven by screws, any rotation direction, compact construction. It can be mounted conveniently.

材料 Materials(to DIN24960)

部件名称 Parts Name	部件材料 Materials		
	670	676	680
旋转环 Rotary Ring	A、U12、Q22		
静止环 Stationary Ring	U2、Q1		
辅助密封 Auxiliary Seal	P、X、V、M1、K		
波纹管 Bellows	M	G1、Y	合金(Alloy)-20
其他结构件材料 Other Parts	M	F、G、G1	合金(Alloy)-20

适用范围 Operating limits

- 压力 Pressure: 真空(Vacuum)~2.0MPa(单层波片Single-Ply)
- 温度 Temperature: -75~200°C
- 线速度 Speeds: ≤25m/sec
- 粘度 Viscosity: ≤1.0Pa.s(1000cp)软对硬(Soft VS Hard)
≤3.5Pa.s(3500cp)硬对硬(Hard VS Hard)

用途 Applications

用于化工、石油化工、炼油、制冷、制药、造纸等工业的泵类的旋转轴密封。
Used in all types of rotating equipment, pumps. To suit industries such as general chemical, oil refining, petrochemical, pharmaceutical, pulp and paper, and waste water treatment.

介质 Medium

- 670: 常用于酸、苛性碱、胺及含硫化氢的含硫水和含硫烃类及其它中等磨蚀及中强腐蚀性介质；
Acid, alkaline liquid, amine, medium corrosive and abrasive fluids such as caustics, salts, and sulfureted hydrogen.
- 676: 常用于水、污水、油、有机溶剂及其它轻微磨蚀及弱腐蚀性介质；
Water, sewage, oil, organic solvents, mild corrosive and abrasives and light corrosives.
- 680: 常用于水、污水、有机溶剂、工艺流体及其它磨蚀及腐蚀性介质；
Water, sewage, organic solvents, process fluids, general purpose for use on a broad range of corrosive and/or abrasive medium.

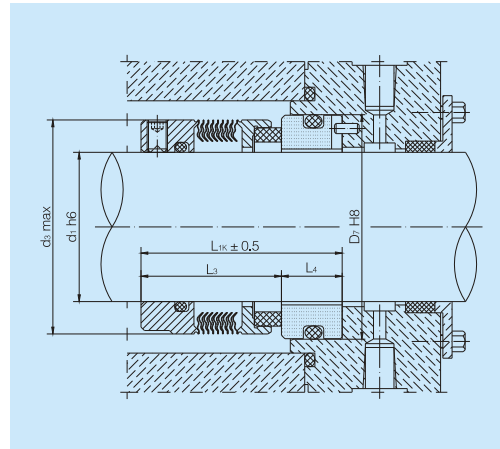

670/676/680公制

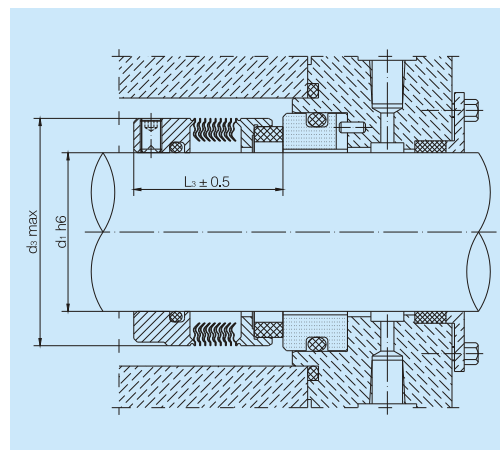
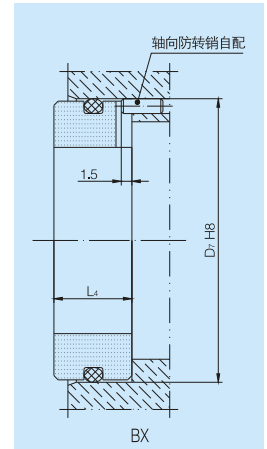

670/676/680英制

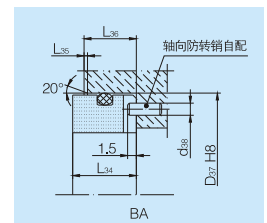
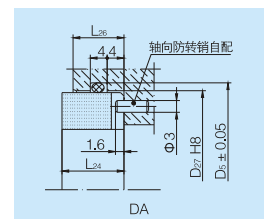

670/676/680公制

型号Model	d ₁	d ₃	D ₇	L _{1K}	L ₃	L ₄
18	18	32.0	33	37.5	27.5	10.0
20	20	33.3	35	37.5	27.5	10.0
22	22	36.0	37	37.5	27.5	10.0
24	24	38.1	39	40.0	30.0	10.0
25	25	39.0	40	40.0	30.0	10.0
28	28	42.0	43	42.5	32.5	10.0
30	30	44.0	45	42.5	32.5	10.0
32	32	46.0	48	42.5	32.5	10.0
33	33	47.0	48	42.5	32.5	10.0
35	35	49.2	50	42.5	32.5	10.0
38	38	52.4	56	45.0	34.0	11.0
40	40	55.6	58	45.0	34.0	11.0
43	43	58.7	61	45.0	34.0	11.0
45	45	58.7	63	45.0	34.0	11.0
48	48	61.9	66	45.0	34.0	11.0
50	50	65.1	70	47.5	34.5	13.0
53	53	68.3	73	47.5	34.5	13.0
55	55	71.0	75	47.5	34.5	13.0
60	60	74.6	80	52.5	39.5	13.0
65	65	84.1	85	52.5	39.5	13.0
70	70	87.3	92	60.0	45.0	15.0
75	75	95.3	97	60.0	45.0	15.0
80	80	98.4	105	60.0	44.5	15.5
85	85	104.8	110	60.0	44.5	15.5
90	90	108.0	115	65.0	49.5	15.5
95	95	114.3	120	65.0	49.5	15.5
100	100	120.7	125	65.0	49.5	15.5

670/676/680英制

型号Model	d ₁	d ₃	D ₅	D ₂₇	D ₃₇	d ₃₈	L ₃	L ₂₄	L ₂₆	L ₃₄	L ₃₅	L ₃₆
0.750	19.05	33.32	37.69	32.00	34.93	2.38	31.75	11.0	10.3	10.3	0.8	8.70
0.875	22.23	36.50	40.87	35.18	38.10	2.38	31.75	11.0	10.3	10.3	0.8	8.70
0.937	23.80	38.10	42.44	36.75	39.67	2.38	31.75	11.0	10.3	11.1	1.2	9.50
1.000	25.40	39.67	44.04	38.35	41.28	2.38	31.75	12.7	11.0	11.1	1.2	9.50
1.125	28.58	42.85	47.22	41.53	44.45	2.38	31.75	12.7	11.0	11.1	1.2	9.50
1.250	31.75	46.02	53.57	47.88	47.63	2.38	33.32	12.7	11.0	11.1	1.2	9.50
1.375	34.93	49.20	56.74	51.05	50.80	2.38	36.50	12.7	11.0	11.1	1.2	9.50
1.500	38.10	52.37	59.92	54.23	53.98	2.38	36.50	12.7	11.0	11.1	1.2	9.50
1.625	41.28	55.55	63.09	57.40	60.33	3.00	36.50	12.7	11.0	12.7	1.2	11.10
1.750	44.45	58.72	66.27	60.58	63.50	3.00	36.50	12.7	11.0	12.7	1.2	11.10
1.875	47.63	61.90	69.44	63.75	66.68	3.00	38.10	12.7	11.0	12.7	1.2	11.10
2.000	50.80	65.07	72.62	66.93	69.85	3.00	38.10	12.7	11.0	12.7	1.2	11.10
2.125	53.98	68.25	75.80	70.10	76.20	3.00	38.10	14.3	12.7	14.3	1.2	12.70
2.250	57.15	71.42	78.97	73.28	79.38	3.00	39.67	14.3	12.7	14.3	1.2	12.70
2.375	60.33	74.60	82.14	76.45	82.55	3.00	39.67	14.3	12.7	14.3	1.2	12.70
2.500	63.50	80.95	88.50	82.80	85.73	3.00	39.67	15.9	14.0	14.3	1.2	12.70
2.625	66.68	84.12	91.67	85.98	85.73	3.00	41.28	15.9	14.0	15.9	1.2	14.30
2.750	69.85	87.30	94.84	89.15	88.90	3.00	41.28	15.9	14.0	15.9	1.2	14.30
2.875	73.03	92.08	98.02	92.32	95.25	3.00	42.85	15.9	14.0	15.9	1.2	14.30
3.000	76.20	95.25	101.20	95.50	98.43	3.00	42.85	15.9	14.0	15.9	1.2	14.30
3.125	79.38	98.43	104.37	98.68	101.60	3.00	44.45	15.9	14.0	15.9	1.2	14.30
3.250	82.55	101.60	107.54	101.85	104.78	3.00	44.45	15.9	14.0	15.9	1.2	14.30
3.375	85.73	104.78	110.72	105.03	107.95	3.00	44.45	15.9	14.0	15.9	1.2	14.30
3.500	88.90	107.95	113.90	108.20	111.13	3.00	47.63	17.4	15.8	15.9	1.2	14.30
3.625	92.08	111.13	120.24	114.55	114.30	3.00	47.63	17.4	15.8	17.4	1.2	17.50
3.750	95.25	114.30	120.24	114.55	117.48	3.00	47.63	17.4	15.8	17.4	1.2	17.50
3.875	98.43	117.48	123.42	117.73	120.65	3.00	47.63	17.4	15.8	17.4	1.2	17.50
4.000	101.60	120.65	126.60	120.90	123.83	3.00	47.63	17.4	15.8	17.4	1.2	17.50